



SALT LAKE CITY FIRE STATION 3

Public art project at 2425 South 900 East, District 7

CALL FOR UTAH ARTISTS: Request for Qualifications

APPLICATION DEADLINE: Tuesday, May 1st by 5:00p.m. MDT

COMMISSION BUDGET: \$70,000

PROJECT BACKGROUND

In the summer of 2017, Salt Lake City Corporation conducted a groundbreaking ceremony for construction at the new site of Fire Station 3, the city's second net-zero energy fire station and only the third net-zero energy fire station in the country. This station will replace the current Station 3, located at 1085 East Simpson Avenue.

The new Fire Station 3 is located in Sugar House, occupying a vacant parking lot directly west of Forest Dale Golf Course. Fire Station 3 will be a Net Zero Energy, LEED Gold Certified facility. The construction incorporates a geo-thermal heating & cooling system, radiant floor heating, LED lighting, a high-performance building envelope and robust photo-voltaic array. A Net Zero Energy building will create as much energy on site as it consumes annually, which is paramount in achieving Salt Lake City's 100 percent renewable-energy initiative.

A panelized, white concrete and natural zinc skin are used to clad the building. These products are sustainable, durable and low-maintenance, but contribute to a dynamic building composition. The architectural form is a result of controlling views, maximizing the solar orientation for the large photo-voltaic array and creating a civic building. Extensive use of wood products at the building's interior walls, millwork and ceiling provide warmth and lend acoustic support to the firefighters' day-to-day experiences. Energy-efficient, operable windows provide abundant natural light, give the occupants control of their environment, and provide a welcoming glow to the public.

As Sugar House continues to expand, it is important to the community and Salt Lake City to maintain and respect the historical integrity of the district. This public art project is, therefore, an opportunity for the art to communicate the historical character of the area and its relationship to the new facility. The artist selected must be capable of creating a prominent piece of artwork, or multiple artworks, addressing the exterior and interior of the building that references or reflects the history of Sugar House. Artists who work with sustainable practices or have lived and worked within the Sugar House community are encouraged to apply.

54 FINCH LANE
SALT LAKE CITY
UTAH / 84102
801.596.5000
saltlakearts.org



PROJECT GOALS & DETAILS

The Salt Lake Art Design Board seeks an artist to create site-specific artwork that:

- Reflects the Salt Lake City Fire Department mission to, “Prepare Effectively, Respond Professionally, and Impact Positively;”
- Reflects the unique and historical identity of the Sugar House community;
- Is visually engaging for passersby and those who use and visit the station;
- Incorporates movement for its effect (kinetic work is not essential but preferred);
- Is of a tranquil nature and reflects health, wellness, and recuperation;
- Responds to the architectural and natural environment;
- Considers and incorporates sustainable concepts and materials that are net zero;
- Is of the highest quality—creatively and technically;
- Is low to no maintenance;
- Meets all public safety, structural, and maintenance standards and complies with the Americans for Disabilities Act (ADA).

PROJECT BUDGET & ELIGIBILITY

The total budget is **\$70,000** and inclusive of artist’s fees and related expense for design, supplies, fabrication, insurance, transportation, permits, and installation. Any fees incurred for design/artwork related engineering, electrical, infrastructure modifications and assistance from the contractors shall be the responsibility of the artist.

This RFQ is open to all professional artists and/or artist-led teams residing in Utah. Artists responding to this call must demonstrate a proficiency in executing work of similar scope and scale.

SELECTION CRITERIA & PROCESS

The Salt Lake Art Design Board, in consultation with project stakeholders, will review all of the properly submitted applications and will recommend one artist/team for the commission to the Mayor for final approval.

In selecting an artist/team for this project the following criteria will be considered:

- Artist’s demonstrated ability to complete work of similar scope and scale and history in creating work that has addressed similar project goals.
- Ability to meet deadlines and budget and to perform work in timely, professional manner.
- The artist’s professional experience is adequate to meet the demands of the project including the ability to work with the Salt Lake Art Design Board, design and construction teams to integrate their artwork into the architecture and/or landscape.
- Ability to understand sense of place and design in a context-sensitive manner as demonstrated by visual documentation.
- Ability to create a noteworthy, engaging site-specific experience.
- Ensure that the artwork is of a permanent nature, does not require excessive maintenance or repair costs and meets public safety issues and Americans for Disabilities Act (ADA) standards.

54 FINCH LANE
SALT LAKE CITY
UTAH / 8 4 1 0 2
801.596.5000
saltlakearts.org



The artist(s) selected for the commission will sign a contract with Salt Lake City Corporation, must carry general liability and auto insurance, and must either provide Workers' Compensation Coverage or apply for a Workers' Compensation Coverage Waiver.

APPLICATION REQUIREMENTS

Submissions that arrive on or before 5:00 p.m. MDT on Tuesday, May 1, 2018 and meet all of the application requirements will be reviewed. Late applications will not be accepted and incomplete applications, including those not formatted correctly, will not be reviewed. To be considered for this project, applicants must submit all of the required materials in the format identified below on a flash drive labeled with applicant's name. DVDs, CDs, paper copies and electronic submissions will not be accepted. Applicants' materials will not be returned. Follow the format below for your documents and images.

1. **LETTER OF INTEREST (first name_last name.letterofinterest.pdf)** One (1) page consisting of no more than 500 words, describing the applicant's interest in, qualifications for, and projects of similar scope/scale.
2. **CURRENT RÉSUMÉ (first name_last name.resume.pdf)** Maximum of two (2) pages per person.
3. **IMAGES OF RECENT WORK (first name_last name01.jpg,first name_last name02.jpg, etc.)** Five (5) to 10 JPG images labeled to correspond with the Image List. Each image must not exceed 1MB in size. No detail shots. Each image must be an image of a completed, installed, public artwork. No proposals please.
4. **IMAGE LIST (first name_last name.imagelist.pdf)** Maximum of 1 page. List title, date, media, size, location, budget and a thumbnail of the image.
5. **PROFESSIONAL REFERENCES:** A list of three (3) prior permanent public art project references with contact information (name, title, organization, mailing address, phone number, and email address), the name and location of the artwork, and a brief description of the relationship. References are **not to exceed one page**. If references do not contain all information asked above, they will be deemed incomplete and your submission will not be considered.

Mail or deliver applications to:

Salt Lake City Arts Council
Fire Station 3
54 Finch Lane
Salt Lake City, UT 84102
Hours: M-F, 9 a.m. to 5 p.m.

Contact:

Dana Hernandez
Dana.Hernandez@slcgov.com

54 FINCH LANE
SALT LAKE CITY
UTAH / 8 4 1 0 2
8 0 1 . 5 9 6 . 5 0 0 0
saltlakearts.org



All contact in regards to this RFQ must occur via email. All questions must be directed to Dana Hernandez, please see the section entitled "Questions" below for additional information. No phone calls will be accepted.

PROJECT SCHEDULE:

Application Deadline – May 1, 2018
Notification of Artist Selection – June 2018
Contract Preparation – June 2018
Expected Fire Station Construction Completion – August 15, 2018
Installation of Artwork – March 2019

Dates are subject to change except the application deadline of Tuesday, May 1, 2018.

QUESTIONS

All questions regarding this RFQ are to be directed only to Salt Lake City Public Art Program Manager at the email address listed below. All questions and responses will be posted at <http://saltlakepublicart.org/for-artists/calls-for-artists/> for all applicants and potential applicants to review. Applicants may be disqualified if any unsolicited contact related to this RFQ is made with an employee of Salt Lake City Corporation, project stakeholders and partners, or the Salt Lake Art Design Board other than the Public Art Program Manager during the selection process. All communication will occur electronically via email. Please review the website below prior to emailing any questions as the website will be updated on a regular basis with questions and answers. Questions will be answered in the order in which they are received. Questions received after April 24th may go unanswered, so it is suggested all interested artists begin the submission process as soon as possible.

Contact: Dana Hernandez, dana.hernandez@slcgov.com

Website: <http://saltlakepublicart.org/for-artists/calls-for-artists/>

SALT LAKE CITY PUBLIC ART PROGRAM

The Public Art Program, which commissions artists' work for City-owned buildings and public spaces, was established by ordinance in 1984. The Salt Lake Art Design Board is an advisory group of citizens representing different City Council districts, appointed by the Mayor and confirmed by the City Council, to oversee Salt Lake City's public art program. They are selected for their related arts expertise and willingness to serve the community. The Design Board is directed, by ordinance, to select artists for public art commissions in Salt Lake City and recommend those artists to the Mayor for final approval. The current Design Board members include Libby Haslam, Jann Haworth, Helen Peters, and Larissa Trout. The Design Board will consult with representatives from the Salt Lake City Fire Department and, the architects Blalock and Partners, to help inform their artist/team selection for this project.

54 FINCH LANE
SALT LAKE CITY
UTAH / 84102
801.596.5000
saltlakearts.org



SALT LAKE CITY CORPORATION ADDITIONAL POLICIES

The artist/team selected for the commission will sign a two-party Artists' Commissioned Work Agreement with Salt Lake City Corporation. A draft agreement that the artist will be expected to sign can be found [here](#).

The City may accept *Request for Qualification (RFQ)* submittals as deemed to be in the public interest; proceed with further selection processes; reject any and all submittals; or may waive any irregularity, informality, or technicality in submittals received. The Mayor, based on the Art Design Board's recommendation, will determine from the submitted information the most qualified Applicant to meet the stated duties as evaluated under the criteria set forth herein. The determination of the most advantageous submittal shall be final and conclusive.

The issuance of the *RFQ* and the receipt and evaluation of the submittals does not obligate the City to select an Applicant Submission or enter into any agreement. A submittal does not constitute business terms under any eventual agreement. The City will not pay costs incurred in responding to the *RFQ* unless specified in the *RFQ*. The City may cancel this process at any time prior to the execution of any agreement without liability.

The City reserves the right to revise the *RFQ* evaluation process. Such revision will be announced in writing to all *RFQ* respondents or short-listed teams, depending on the timing of the change. The City also reserves the right to reject any and all *RFQ* responses at any time, or to terminate any negotiations implied in this *RFQ* or initiated subsequent to it. If the Art Design Board receives a submittal it deems incomplete or ambiguous, it reserves the right to request additional information or to reject the submittal.

The Salt Lake Art Design Board and Salt Lake City Corporation reserve the right to reject any or all applications, to reissue the Call for Entries (*RFQ*), or to terminate the selection process or project at any time without prior notice. No applicant shall have the right to make a claim against the Salt Lake City Corporation in the event the *RFQ* is canceled, or the City decides not to proceed with the selection or commissioning process, awards a contract, or determines not to award any or all contracts specified in this document. No protests will be accepted or reviewed. All submissions are subject to [City Code 2.44](#), governing conflicts of interest.

The City reserves the right to, at any time and for any reason, discontinue negotiations with any initially selected Applicant, and to pursue negotiations with an alternative team. Applicants or their agents are instructed not to contact Art Design Board members, City officials or employees or attempt to externally manipulate or influence the procurement process in any way, other than through the instructions contained herein, from the date of release of this *RFQ* to the date of execution of an Agreement resulting from this solicitation. City, in its sole discretion, may disqualify Applicants who violate this paragraph.



**INTERIOR LOCATION:
EAST AND/OR WEST WALLS
OF PUBLIC STAIR; VISIBLE
THROUGH GLASS WINDOWS.**

**INTERIOR LOCATION:
NORTH AND/OR EAST WALLS
OF LOBBY AREA; VISIBLE
THROUGH GLASS WINDOWS.**

**OPEN LANDSCAPE AREAS CAN BE
MODIFIED TO RECEIVE THREE-
DIMENSIONAL ART. THESE MIGHT
BE AREAS WHERE THE ART IS
ABOUT "BRIDGING PAST &
PRESENT" RELATIVE TO THE
HISORIC CLUBHOUSE AND NEW
FIRE STATION...**



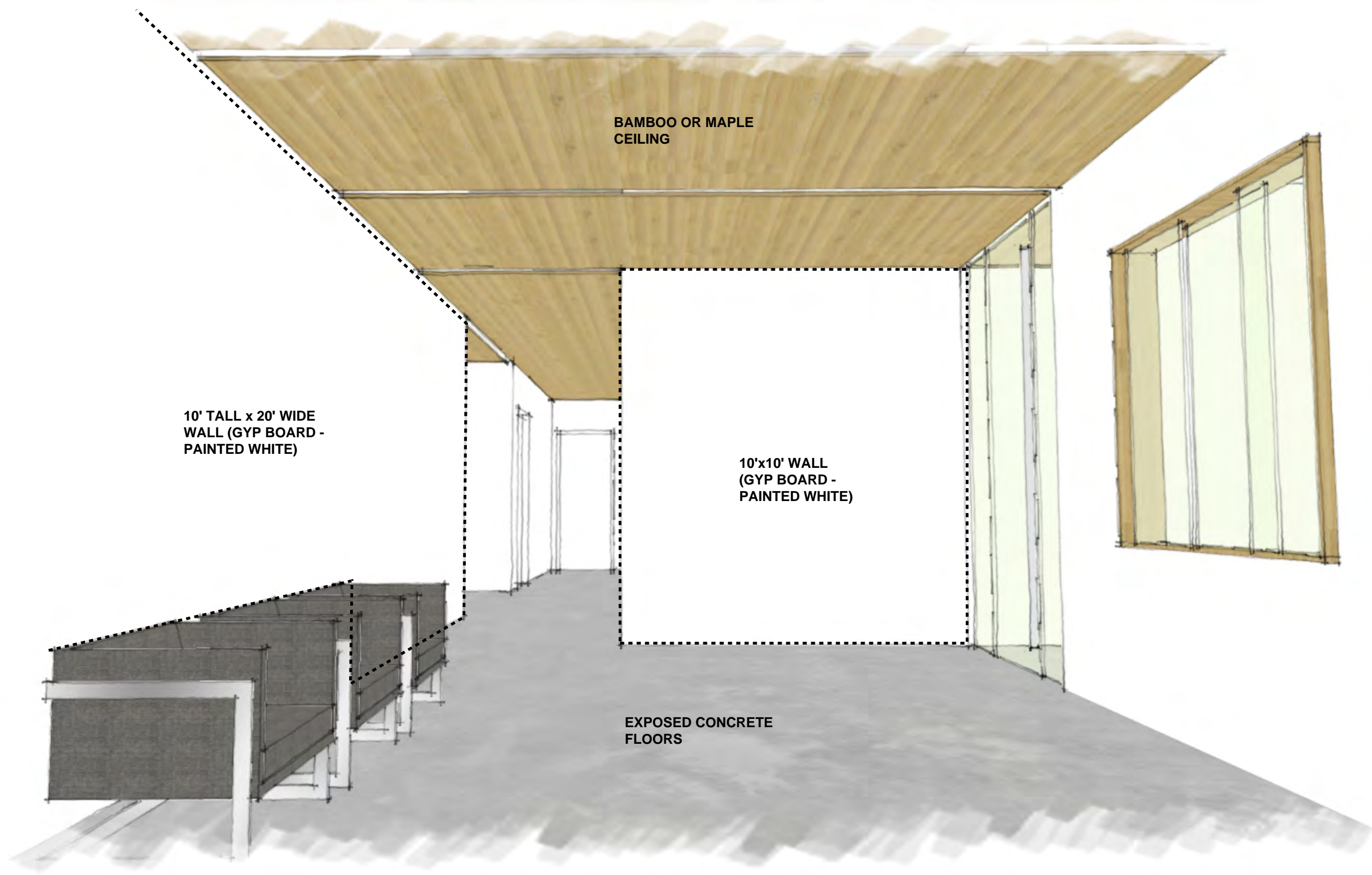

BAMBOO OR MAPLE
CEILING

10' TALL x 20' WIDE
WALL (GYP BOARD -
PAINTED WHITE)

10'x10' WALL
(GYP BOARD -
PAINTED WHITE)

EXPOSED CONCRETE
FLOORS



~25' TALL x 20' WIDE
WALL (GYP BOARD -
PAINTED WHITE)

The diagram shows a cross-section of a staircase and wall. The staircase is made of wood treads and is supported by a steel frame. The wall is made of gypsum board and is painted white. The ceiling is made of wood planks. The floor is made of concrete. The wall is 25 feet tall and 20 feet wide. The staircase is 10 feet tall and 25 feet wide. The wall is made of gypsum board and is painted white. The ceiling is made of wood planks. The floor is made of concrete.

~10' TALL x 25' WIDE
WALL (GYP BOARD -
PAINTED WHITE)

STEEL AND WOOD
STAIR

An architectural rendering of a building's interior. On the left, two women are shown in black silhouette, standing and talking. The woman on the left is holding a child. They are positioned in front of a wall that is partially wood-paneled and partially white. To the right, a glass-walled structure, possibly a staircase or a viewing area, is visible. The background shows a landscape with mountains under a cloudy sky. A dashed line indicates the top edge of the white wall section.

~25' TALL x 20' WIDE
WALL (GYP BOARD -
PAINTED WHITE)

10' WIDE x18' DEEP
CEILING ABOVE STAIR
(WHITE ACOUSTICAL
TILE)

